

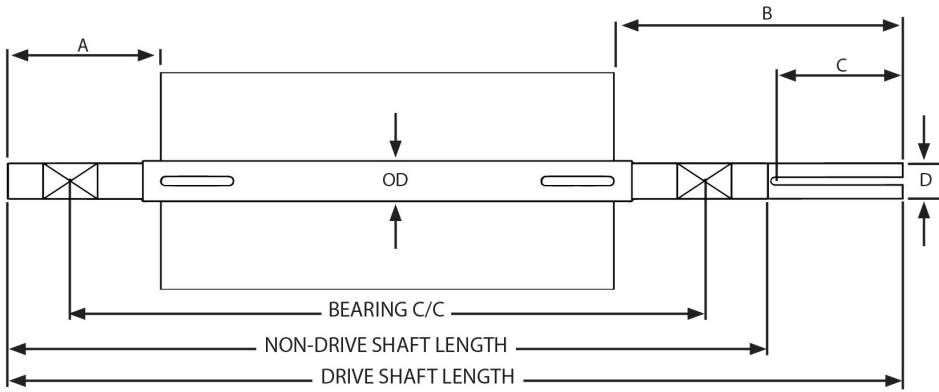

PULLEY DATA SHEET (Single Turn down)

Company: _____ Contact: _____ Phone: _____

Email: _____ Pulley ID: _____ Quantity: _____



Additional Information

- | | | | | | |
|---|----------|-----------|------------------|--------------|-------------|
| 1. PULLEY POSITION/LOCATION: | DRIVE | NON-DRIVE | SNUB | TAIL | OTHER _____ |
| 2. PULLEY TYPE: | DRUM | WING | | | |
| 3. PULLEY FACE TYPE: | FLAT | CROWN | | | |
| 4. PULLEY DUTY: | STANDARD | MINE | ENGINEERED CLASS | | |
| 5. BALANCED: | YES | NO | | | |
| 6. DIAMETER x FACE WIDTH (in): | _____ | | | | |
| 7. SHELL THICKNESS: | _____ | | | | |
| 8. CENTER PLATE THICKNESS: | _____ | | | | |
| 9. END PLATE THICKNESS: | _____ | | | | |
| 10. HUB TYPE | XT | QD | KEYLESS | WELDED SHAFT | |
| 11. HUB PART NUMBER: | _____ | | | | |
| 12. BUSHING BORE: | _____ | | | | |
| 13. LAGGING THICKNESS: | 1/4" | 1/2" | 3/8" | 5/8" | 1" _____ |
| 14. LAGGING TYPE: | PLAIN | DIAMOND | WELD-ON | CERAMIC | HTV DBCL |
| 15. BEARING C/C: | _____ | | | | |
| 16. BEARING PART NUMBER: | _____ | | | | |
| 17. NON-DRIVE SHAFT LENGTH: | _____ | | | | |
| 18. DRIVE SHAFT LENGTH: | _____ | | | | |
| 19. PULLEY OFFSET - DIM A: | _____ | | | | |
| 20. PULLEY OFFSET - DIM B: | _____ | | | | |
| 21. DRIVE KEY LENGTH - DIM C (before radius): | _____ | | | | |
| 22. SHAFT DIA. THRU PULLEY - DIM OD: | _____ | | | | |
| 23. SHAFT DIA. THRU BEARING - DIM D: | _____ | | | | |
| 24. SHAFT MATERIAL: | C1018 | 1045 | 4140 | OTHER _____ | |